

# EKI-2525P

# EKI-2526PI

## 5-port Industrial PoE Switch

## 6-port Industrial PoE Switch with Wide Temperature



EKI-2525P

EKI-2526PI



### Features

- Provides 5/6 Fast Ethernet ports with 4 PoE ports with injector function
- Supports 10/100 Mbps Auto Negotiation
- Provides broadcast storm protection
- Supports Ethernet ESD protection
- Provides Slim size, DIN-rail/Wall mount with IP30 metal mechanism
- Supports Redundant 48 V<sub>DC</sub> power input and P-Fail relay
- Supports operating temperatures from -10 to 60°C (EKI-2525P)
- Supports wide operating temperature -40 ~ 75°C (EKI-2526PI)

### Introduction

The EKI-2525P is a 5-port unmanaged PoE (Power-over-Ethernet) Industrial Ethernet switch and EKI-2526PI is a 6-port unmanaged PoE Industrial Ethernet switch, they support 4 PoE ports which are classified as power source equipments (PSE). The PoE devices makes centralized power supply come true and provides up to 15.4 watts of power per port. Advantech EKI PoE devices can be used to power IEEE 802.3af compliant powered devices (PD) by Ethernet cable and eliminates the need for additional power wiring. Advantech EKI PoE devices come equipped with all the standard features of the EKI family. Furthermore, it offers a 48 V<sub>DC</sub> redundant power input design (EKI-2525P/EKI-2526PI), and is secured with a double protection mechanism; Power Polarity Reverse Protect and an Overload Current Resettable Fuse. Advantech EKI PoE devices come with compact metal housing that rates IP30 to help against from dusty industrial environments.

### Specifications

#### Communications

- **Standard** IEEE 802.3, 802.3u, 802.3x, 802.3af
- **LAN** 10/100Base-T (X)
- **Transmission Distance** Ethernet: Up to 100 m (EKI-2525P/EKI-2526PI)
- **Transmission Speed** Up to 100 Mbps

#### Fiber Optics (EKI-252SPI)

- **Single-mode** 1310 nm  
Tx Power: -8/-15 dBm  
Rx Sensitivity: -34 dBm  
Parameters: 9/125 um

#### Interface

- **Connectors** PoE Ports: 4 (Ports 1 ~ 4)  
Ethernet x1 (EKI-2525P)  
Ethernet x2 (EKI-2526PI)  
6-pin removable screw terminal (power & relay)
- **LED Indicators** P1, P2, P-Fail  
10/100TX: Link/Activity, Duplex/Collision

#### Power

- **Power Consumption** EKI-2525P: 65 W (Full load PoE)  
EKI-2526PI: 62.6 W (Full load PoE)
- **Power Input** 48 V<sub>DC</sub> (EKI-2525P/EKI-2526PI), redundant dual inputs
- **Power Output** 15.4 W at 48 V (per PoE port)
- **Fault Output** 1 Relay Output

#### Mechanism

- **Dimensions (W x H x D)** 37 x 140 x 95 mm (1.46" x 5.51" x 3.74") (EKI-2525P)  
48.6 x 140 x 95 mm (1.91" x 5.51" x 3.74") (EKI-2526PI)
- **Enclosure** IP30, Metal shell with solid mounting kits
- **Mounting** DIN-rail, Wall

#### Protection

- **Reverse Polarity** Present
- **Overload current** Present

#### Environment

- **Operating Temperature** -10 ~ 60°C (14 ~ 140°F) (EKI-2525P)  
-40 ~ 75°C (-40 ~ 167°F) (EKI-2526PI)
- **Storage Temperature** -40 ~ 85°C (-40 ~ 185°F)
- **Operating Humidity** 5 ~ 95% (non-condensing)
- **Storage Humidity** 0 ~ 95% (non-condensing)
- **MTBF** 440,132 hours

#### Certification

- **Safety** UL 60950-1, CAN/CSA-C22.2 No.60950
- **EMI** FCC Part 15 Subpart B Class A, EN 55022 Class A
- **EMS** EN 61000-4-2  
EN 61000-4-3  
EN 61000-4-4  
EN 61000-4-5  
EN 61000-4-6  
EN 61000-4-8
- **Shock** IEC 60068-2-27
- **Freefall** IEC 60068-2-32
- **Vibration** IEC 60068-2-6

## Dimensions

Unit: [mm]

### EKI-2525P

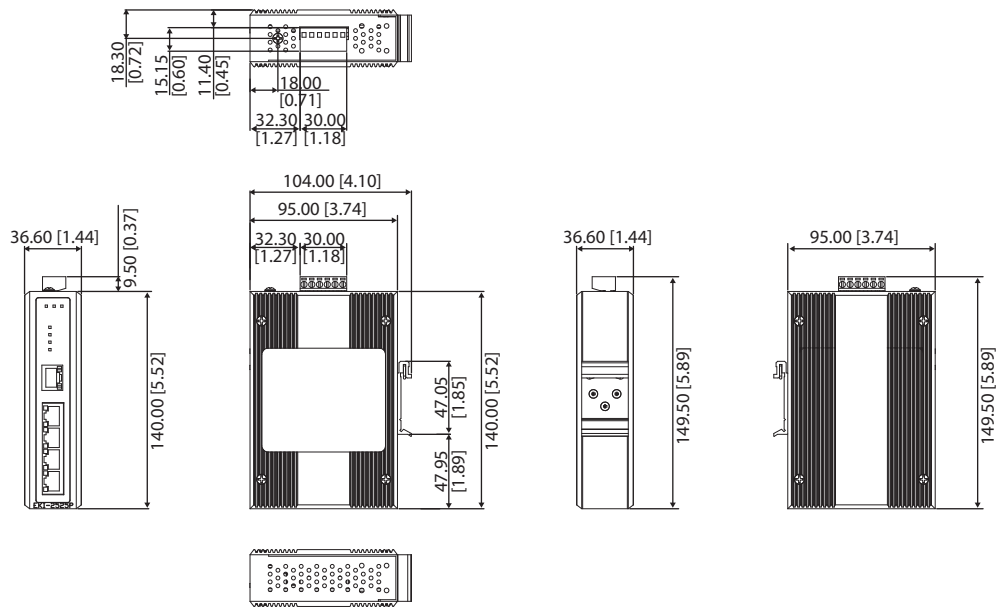

**Panel Cut-out Dimensions: 104.00 x 140.00 x 36.60 mm (4.10" x 5.52" x 1.44")**

### EKI-2526PI

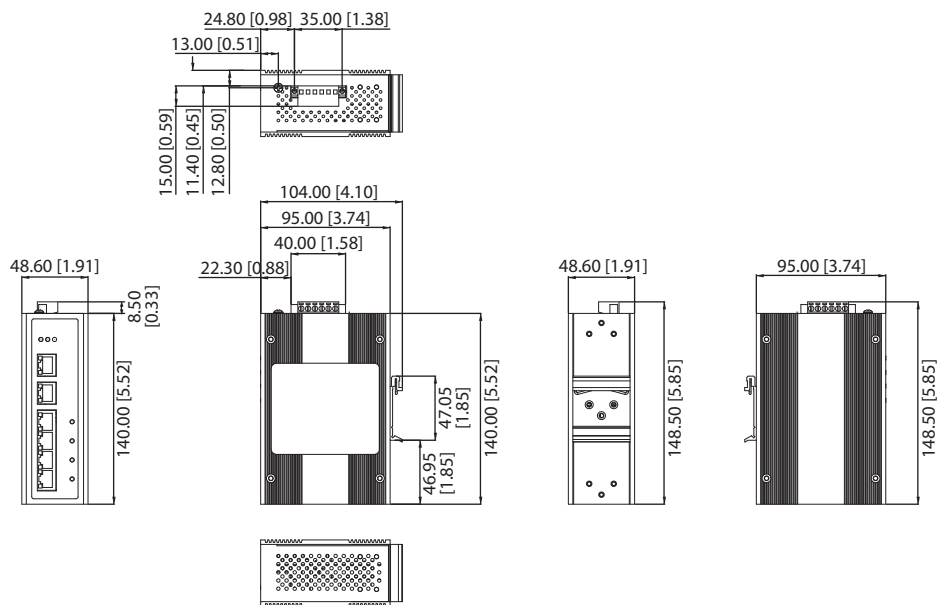

**Panel Cut-out Dimensions: 104 x 140 x 48.6 mm (4.1" x 5.52" x 1.91")**

## Ordering Information

- EKI-2525P 5-port Switch with 4 port-PoE
- EKI-2526PI 6-port Switch with 4 port-PoE



[www.L-TronDirect.com](http://www.L-TronDirect.com)

800-830-9523

[info@L-Tron.com](mailto:info@L-Tron.com)

596 Fishers Station Dr | Victor, NY | 14564 | Suite 1 A

[www.L-Tron.com](http://www.L-Tron.com)

Get in touch with us  
on social media!

