

Ultra Compact Ethernet Serial Servers

VESP211 Series

B+B SMARTWORX

Powered by

ADVANTECH



PRODUCT FEATURES

- Ethernet enable serial devices
- Ultra compact design fits into the tightest spaces
- RS-232, RS-422/485, and RS-232/422/485 models
- TCP/IP interface
- Windows utility for configuration
- Industrial EMC specifications
- IP30 metal enclosure
- UL 60950 Listed

VESP211 Serial Servers connect serial devices (RS-232, RS-422 or RS-485) to Ethernet networks, allowing the serial device to become a node on the network. The serial port can be accessed over a LAN/WAN using Direct IP Mode, Virtual COM Port, or Paired Mode connections. VESP211 Serial Servers feature 10BaseT or 100BaseTX copper network. The product is built for use in harsh environments, featuring a heavy duty metal enclosure that is panel (standard) or DIN rail mountable (with optional adaptor). The product can operate from a range of DC power inputs and features a barrel connector. It is shipped with a power supply that features a universal AC input with interchangeable blades for North America, Europe, UK, Australia, and China.

Ease of Use

Configuration, upgrades and monitoring are simple, easy tasks with Vlinx™ Manager Software. It installs right on your PC giving you access to the serial server via your desktop. Manage remotely over a LAN or WAN via the built-in web server. This is helpful for off-site troubleshooting and can be done with a simple web browser.

ORDERING INFORMATION

| MODEL NUMBER | SERIAL PROTOCOL | SERIAL PORT | ETHERNET PORTS | ETHERNET CONNECTOR |
|------------------------|-----------------|--------------------------|----------------|--------------------|
| US Power Supply | | | | |
| VESP211 | RS-232/422/485 | DB9M | 1 | RJ45 |
| VESP211-232 | RS-232 | DB9M | 1 | RJ45 |
| VESP211-485 | RS-422/485 | Removable Terminal Block | 1 | RJ45 |

ACCESSORIES

232NM9 - Null Modem Crossover Cable for DTE to DTE connection

DRAD35 - DIN Rail Adaptor Clip (pair)

PS12VDC1A - Replacement Power Supply

SM16-12-V-ST - Replacement Power Supply with International Blade Kit

Ultra Compact Ethernet Serial Servers

VESP211 Series



SPECIFICATIONS

| SERIAL TECHNOLOGY | |
|--------------------------------|--|
| RS-232 (DB9) | TD, RD, DTR, DSR, RTS, CTS, DCD plus Signal Ground |
| RS-485 2-Wire | Data A(-), Data B(+), GND |
| RS-422/485 4-Wire | TDA(-), TDB(+), RDA(-), RDB(+), GND |
| Serial Protocols & Connectors: | |
| | VESP211: RS-232/422/485 (DB9 male) |
| | VESP211-232: RS-232 (DB9 male) |
| | VESP211-485: RS-422/485 (removeable terminal block) |
| Data Rate | Up to 230.4 Kbps |
| POWER | |
| Source | Power supply included |
| Input Voltage | 10 to 30 VDC |
| Power Connector Dimensions | 5.5 x 2.1 mm |
| Power Consumption | 2.5 Watts Max. |
| POWER SUPPLY (INCLUDED) | |
| Input Voltage | 90 to 264 VAC |
| Frequency | 47 to 63 Hz |
| Power Consumption | No load; Level VI = 0.1W; ErP Tier 1 = 0.075W |
| Operating Temperature | 0 to +40 °C |
| Storage Temperature | -10 to +70 °C |
| Operating Humidity | 20 to 80% |
| Storage Humidity | 10 to 90% |
| Internation Blade Kit | North America, Europe, U.K., Australia, China, Japan |
| MECHANICAL | |
| LED Indicators | Serial Port, Ethernet, Ready LED's |
| Switches | Reset Button |
| Dimensions | VESP211 - 7.938 x 5.257 x 2.209 cm (3.125 x 2.070 x 0.870 in) |
| Enclosure | Metal, IP 30 |
| ENVIRONMENTAL | |
| Operating Temperature | -40 to +80°C (-40 to +176°F) |
| Operating Humidity | 10 to 95% Non-condensing |
| MTBF | VESP211: xxx hours VESP211-232: xxx hours VESP211-485: xxx hours |
| MTBF Calculation Method | MIL 217 F Parts Count Reliability Prediction |

| NETWORK | |
|--------------------------------------|--|
| Serial Memory | 8 KB per port |
| Network Memory | 4 KB |
| LAN | 10/100 Mbps Auto-detecting, 10BaseT or 100BaseTX |
| Ethernet | IEEE 802.3 auto detecting & auto MDI/MDI-X, 10BaseT and 100Base TX |
| PROTOCOLS | |
| Protocols | TCP, IPv4, UDP, ARP, HTTP 1.0, ICMP/PING, DHCP/BOOTP |
| IP Mode | Static, DHCP |
| TCP/UDP | User definable |
| UDP | Unicast or Multicast |
| OTHER | |
| Connection Mode | Server, Client, VCOM, Paired |
| Client Connection | At power up or upon data arrival |
| Search | Serial direct COM and Ethernet Auto Search or specific IP |
| Diagnostics | Display PC IP, ping, test VCOM |
| Firmware Upgrade | via Vlinx™ Manager |
| CONFIGURATION SOFTWARE | |
| Vlinx™ Manager | Windows XP (32/64 bit), 2003 Server (32/64 bit), Vista (32/64 bit), 2008 Server (32/64 bit), Windows 7 (32/64 bit), Windows 8/8.1 (32/64 bit) |
| REGULATORY / CERTIFICATIONS / SAFETY | |
| Compliance | FCC Part 15 Class B 2004/108/EC, Electromagnetic Compatibility Directive 2011/65/EU, Reduction of Hazardous Substances Directive EN55022:2010+AC:2011, Information Technology Equipment - Class B RF Emissions EN55024:2010, Information Technology Equipment - Immunity (Light Industrial Environments) |
| EMC | EN61000-4-2:2009, ESD Immunity EN61000-4-3:2006+A2:2010, Radiated Field Immunity (RFI) EN61000-4-4:2012, EFT/Burst Immunity EN61000-4-5:2006, Electrical Surges Immunity EN61000-4-6:2009, RF Conducted Immunity |
| UL | UL 60950 File# E353510 |

MECHANICAL DIAGRAM - VESP-211-485-X MODELS

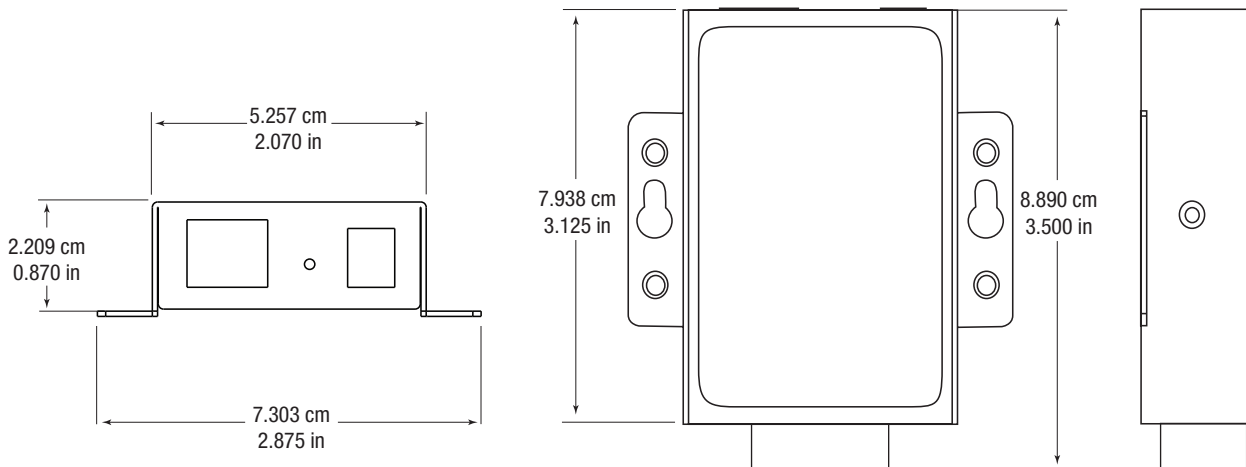



www.L-TronDirect.com

800-830-9523

info@L-Tron.com

596 Fishers Station Dr | Victor, NY | 14564 | Suite 1 A

www.L-Tron.com

